

# MAIN SWITCHES, CONTROL SWITCHES, COMMAND AND SIGNALLING DEVICES

## SYSTEM OVERVIEW SERIES MS

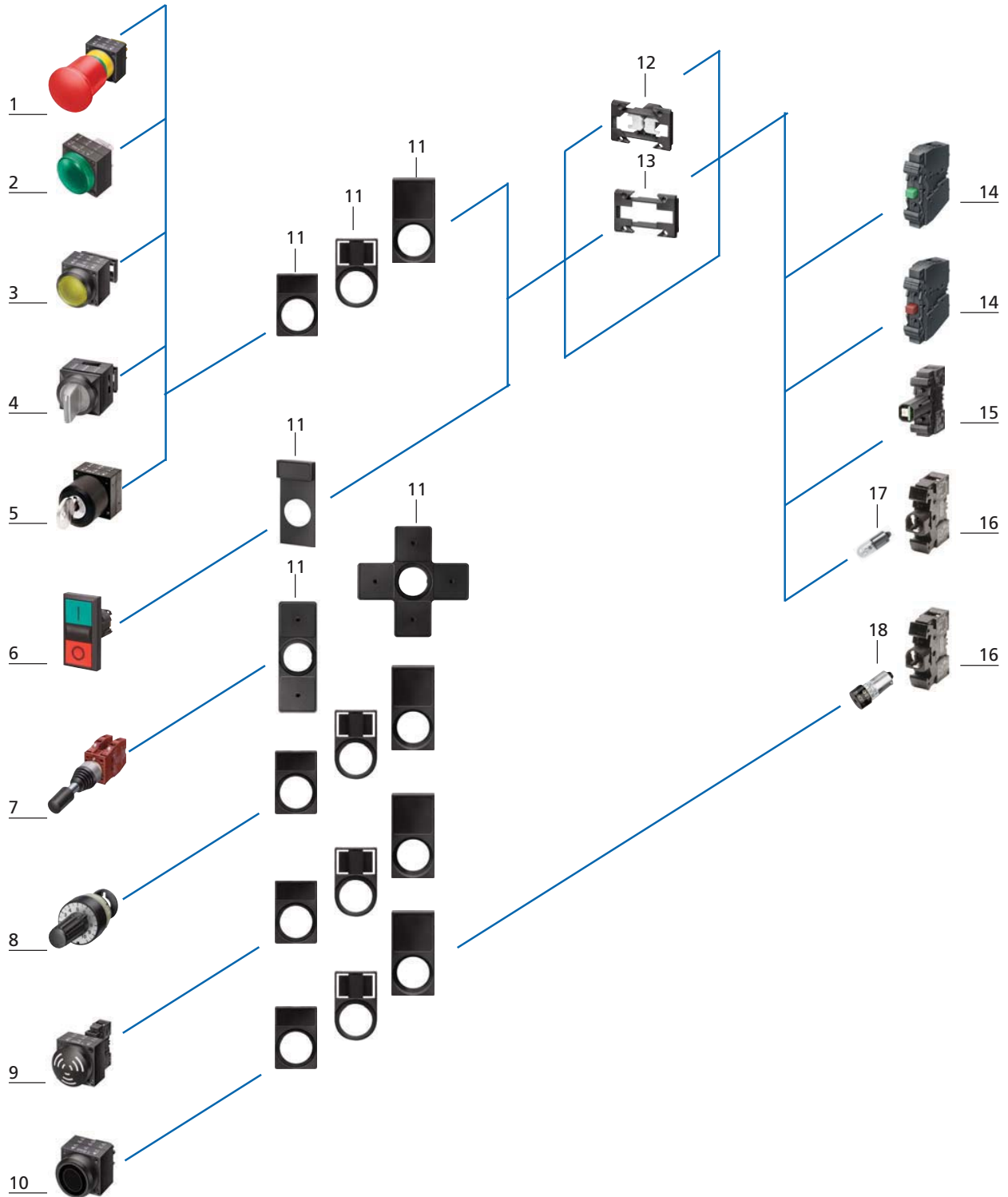

- 1 Emergency stop buttons
- 2 Signal lamp
- 3 Push buttons
- 4 Knob for selector switches
- 5 Key buttons
- 6 Double push buttons
- 7 Joysticks
- 8 Potentiometer knob
- 9 Buzzers complete

- 10 Cover for buzzer
- 11 Label holder
- 12 Carrier for 3 contact blocks
- 13 Carrier for 2 contact blocks + lamp
- 14 Contact block
- 15 LED
- 16 Lamp holder
- 17 Lamp
- 18 Buzzer insert

# MAIN SWITCHES, CONTROL SWITCHES, COMMAND AND SIGNALLING DEVICES

## SERIES MS – SETS



MSL14103C



MSM12003C



MSN12260RD



MST14100C



MSG13400RD

## SCHRACK INFO

- Pre-configured sets consisting of:
  - Command or signalling device
  - Holder and carrier
  - LED
  - Auxiliary contacts

## DIMENSIONS

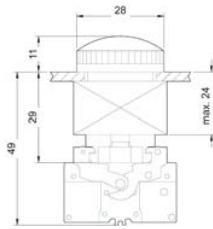

m\_MSMKPL

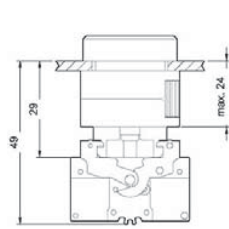

m\_MSTKPL

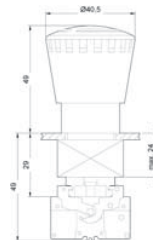

m\_MSN12260RD

DESCRIPTION	EAN CODE	AVAILABLE	ORDER NO.
SET push-button, red, 1 NC, spring-type terminals	9004840671568		<b>MS12200C</b>
SET push-button, green, 1 NO, spring-type terminals	9004840671605		<b>MST14100C</b>
SET push-button illum., green, 230V, 1 NO, spring-type terminals	9004840671278		<b>MSL14103C</b>
SET push-button illum., red, 230V, 1 NC, spring-type terminals	9004840671216		<b>MSL12203C</b>
SET push-button illum., green, 24V, 1 NO, spring-type terminals	9004840671285		<b>MSL14105C</b>
SET push-button illum., red, 24V, 1NC, spring-type terminals	9004840671223		<b>MSL12205C</b>
SET signal lamp, green, 230V, spring-type terminals	9004840671377		<b>MSM14003C</b>
SET signal lamp, red, 230V, spring-type terminals	9004840671339		<b>MSM12003C</b>
SET signal lamp, green, 24V, spring-type terminals	9004840671384		<b>MSM14005C</b>
SET signal lamp, red, 24V, spring-type terminals	9004840671346		<b>MSM12005C</b>
SET Emerg.-Stop push-button red, "NOT-HALT", 1 NC, rot. release	9004840671438		<b>MSN12260RD</b>
SET Emerg.-Stop m/head PB, 2NC, box yellow, rot. rel., w/o collar	9004840670776		<b>MSG13400RD</b>



## I KNOW WHERE TO FIND IT!

### WITH THE SCHRACK TECHNIK LIVE-PHONE APP

- Access technical product information at any time and from everywhere
- See availability and price immediately
- Order desired products easily

# MAIN SWITCHES, CONTROL SWITCHES, COMMAND AND SIGNALLING DEVICES

## ■ SERIES MS – PUSHBUTTONS



MST14000

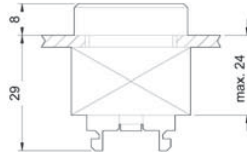

DIMENSIONS

### ■ SCHRACK INFO

- IP 66
- Diameter 29.5 mm
- Button plates with inscription for transparent push-buttons see page 881

DESCRIPTION	EAN CODE	AVAILABLE	ORDER NO.
<b>SPRING-RETURN</b>			
Push-button, black	9004840671537		<b>MST11000</b>
Push-button, black, "0"	9004840671544		<b>MST11040</b>
Push-button, red	9004840671551		<b>MST12000</b>
Push-button, red, "0"	9004840672602		<b>MST12040</b>
Push-button, yellow	9004840671575		<b>MST13000</b>
Push-button, green	9004840671582		<b>MST14000</b>
Push-button, green, "1"	9004840671599		<b>MST14010</b>
Push-button, blue	9004840671612		<b>MST15000</b>
Push-button, white	9004840671629		<b>MST16000</b>
Push-button, white, "1"	9004840671636		<b>MST16010</b>
Push-button, transparent	9004840672701		<b>MST17000</b>

### LATCHING

Push-button, black, latching	9004840672619		<b>MST11000R</b>
Push-button, red, latching	9004840672626		<b>MST12000R</b>
Push-button, yellow, latching	9004840672633		<b>MST13000R</b>
Push-button, green, latching	9004840672640		<b>MST14000R</b>
Push-button, blue, latching	9004840672657		<b>MST15000R</b>
Push-button, white, latching	9004840672664		<b>MST16000R</b>

## ■ SERIES MS – TWIN-PUSHBUTTON



MST29020

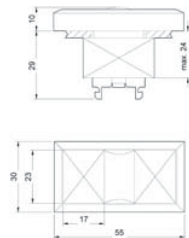

DIMENSIONS

### ■ SCHRACK INFO

- IP 65
- Holder included

DESCRIPTION	EAN CODE	AVAILABLE	ORDER NO.
Twin push button illum., green/red, "I/O"	9004840671643		<b>MST29020</b>

# MAIN SWITCHES, CONTROL SWITCHES, COMMAND AND SIGNALLING DEVICES

## ■ SERIES MS – MUSHROOM PUSHBUTTONS



MSP14000

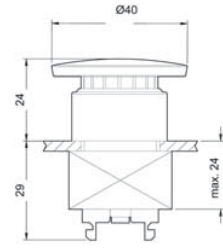

DIMENSIONS

### ■ SCHRACK INFO

- IP 66

DESCRIPTION	EAN CODE	AVAILABLE	ORDER NO.
<b>SPRING-RETURN</b>			
Mushroom push-button, black	9004840671452		<b>MSP11000</b>
Mushroom push-button, red	9004840671469		<b>MSP12000</b>
Mushroom push-button, green	9004840671483		<b>MSP14000</b>
<b>LATCHING</b>			
Mushroom push-button, red, latching, pull release	9004840671476		<b>MSP12000RZ</b>

## ■ SERIES MS – EMERGENCY STOP PUSHBUTTONS



MSN12000RZ



MSN12000RD



MSNV2000RS

### ■ SCHRACK INFO

- IP 66
- Tamperproof

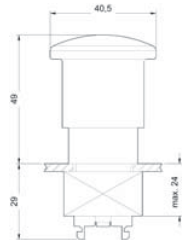

DIMENSIONS

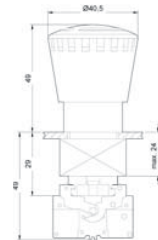

DIMENSIONS

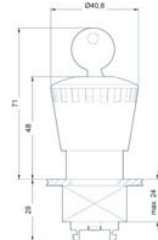

DIMENSIONS

DESCRIPTION	EAN CODE	AVAILABLE	ORDER NO.
Emergency-Stop push-button, red, pull release, w. mech. pos.-indication	9004840671414		<b>MSN12000RD</b>
Emergency-Stop push-button, red, 40mm dia, pull release	9004840671421		<b>MSN12000RZ</b>
Emergency-Stop push-button red, 40mm dia, key release, Ronis	9004840671445		<b>MSNV2000RS</b>



Order no. blue: on stock, usually ready for delivery on the day of order!



# MAIN SWITCHES, CONTROL SWITCHES, COMMAND AND SIGNALLING DEVICES

## ■ SERIES MS – KEY OPERATED SWITCHES



MSS11020RS

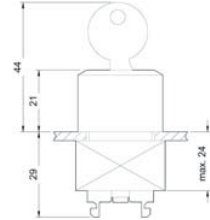

DIMENSIONS

### ■ SCHRACK INFO

- IP 66
- 2 keys Ronis SB30 included
- Diameter 28.5 mm

DESCRIPTION	EAN CODE	AVAILABLE	ORDER NO.
Key switch button, 2pos., 50°, Ronis SB30	9004840671506		<a href="#">MSS11020T</a>
Key switch button, 2pos., 50°, latching, Ronis SB30	9004840671490		<a href="#">MSS11020RS</a>
Key switch button, 3pos., 2x50°, latching	9004840671513		<a href="#">MSS11030RS</a>

## ■ SERIES MS – JOYSTICKS



MSJ11320RH



MSJ11740R

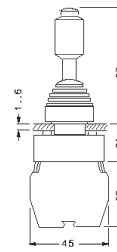

DIMENSIONS

DESCRIPTION	EAN CODE	AVAILABLE	ORDER NO.
Joystick 2pos., horizontal, 2 NO	9004840670844		<a href="#">MSJ11320TH</a>
Joystick 2pos., vertical, 2 NO	9004840670851		<a href="#">MSJ11320TV</a>
Joystick 2pos., latching horizontal, 2 NO	9004840670820		<a href="#">MSJ11320RH</a>
Joystick 2pos., latching vertical, 2 NO	9004840670837		<a href="#">MSJ11320RV</a>
Joystick 4pos., 4 NO	9004840670875		<a href="#">MSJ11740T</a>
Joystick 4pos., latching, 4 NO	9004840670868		<a href="#">MSJ11740R</a>

## ■ SERIES MS – SIGNAL LAMPS



MSM14000

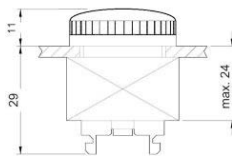

DIMENSIONS

### ■ SCHRACK INFO

- IP 66
- Diameter 28 mm
- LED or lampholder + lamps can be snapped on

DESCRIPTION	EAN CODE	AVAILABLE	ORDER NO.
Signal lamp, red	9004840671322		<a href="#">MSM12000</a>
Signal lamp, yellow	9004840671353		<a href="#">MSM13000</a>
Signal lamp, green	9004840671360		<a href="#">MSM14000</a>
Signal lamp, blue	9004840671391		<a href="#">MSM15000</a>
Signal lamp, white	9004840671407		<a href="#">MSM16000</a>
Signal lamp, transparent	9004840672718		<a href="#">MSM17000</a>



# MAIN SWITCHES, CONTROL SWITCHES, COMMAND AND SIGNALLING DEVICES

## ■ SERIES MS – ACOUSTIC INDICATORS, BUZZER AND SOCKET



MSA1000



MSA0000



MSA0005



MSZF0000

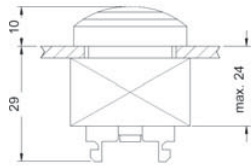

DIMENSIONS

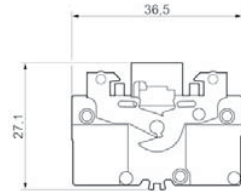

DIMENSIONS

### ■ SCHRACK INFO

- 80 dB continuous tone
- 24 V AC/DC, 230 V AC/DC
- Diameter 28 mm
- 100% duty cycle

DESCRIPTION	EAN CODE	AVAILABLE	ORDER NO.
Acoustic indicator, cont.tone 2,4 kHz, compl., 24VACDC, IP65	9004840670745		<a href="#">MSA10005</a>
Acoustic indicator, cont.tone 2,4 kHz, compl., 230VACDC, IP65	9004840670752		<a href="#">MSA1000F</a>
Cover for buzzer (IP40)	9004840670714		<a href="#">MSA00000</a>
Buzzer, cont. tone, 24VDC, (f. socket BA9s)	9004840670738		<a href="#">MSA00005</a>
Bulb socket BA9s	9004840671650		<a href="#">MSZF0000</a>

## ■ SERIES MS – ILLUMINATED PUSHBUTTONS



MSL13000

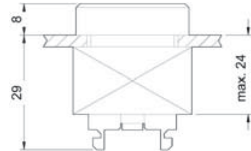

DIMENSIONS

### ■ SCHRACK INFO

- IP 66
- Diameter 28.5 mm
- Carrier included for 2 contact elements + LED

DESCRIPTION	EAN CODE	AVAILABLE	ORDER NO.
<b>SPRING-RETURN</b>			
Push-button illum., red	9004840671193		<a href="#">MSL12000</a>
Push-button illum., yellow	9004840671230		<a href="#">MSL13000</a>
Push-button illum., green	9004840671254		<a href="#">MSL14000</a>
Push-button illum., blue	9004840671292		<a href="#">MSL15000</a>
Push-button illum., white	9004840671308		<a href="#">MSL16000</a>
Push-button illum., transparent	9004840672671		<a href="#">MSL17000</a>
<b>LATCHING</b>			
Push-button illum., red, latching	9004840671209		<a href="#">MSL12000R</a>
Push-button illum., yellow, latching	9004840671247		<a href="#">MSL13000R</a>
Push-button illum., green, latching	9004840671261		<a href="#">MSL14000R</a>
Push-button illum., blue, latching	9004840672695		<a href="#">MSL15000R</a>
Push-button illum., white, latching	9004840671315		<a href="#">MSL16000R</a>
Push-button illum., transparent, latching	9004840672688		<a href="#">MSL17000R</a>



Order no. blue: on stock, usually ready for delivery on the day of order!



# MAIN SWITCHES, CONTROL SWITCHES, COMMAND AND SIGNALLING DEVICES

## ■ SERIES MS – TRANSPARENT BUTTON PLATES WITH INSCRIPTION FOR ILLUMINATED AND TRANSPARENT PUSHBUTTONS



MSZS700128



MSZS701028

DESCRIPTION	EAN CODE	AVAILABLE	ORDER NO.
Plate 28mm dia, transparent, "0"	9004840672299		<a href="#">MSZS700028</a>
Plate 28mm dia, transparent, "1"	9004840672305		<a href="#">MSZS700128</a>
Plate 28mm dia, transparent, "EIN"	9004840672312		<a href="#">MSZS700228</a>
Plate 28mm dia, transparent, "AUS"	9004840672329		<a href="#">MSZS700328</a>
Plate 28mm dia, transparent, "AUF"	9004840672336		<a href="#">MSZS700428</a>
Plate 28mm dia, transparent, "AB"	9004840672343		<a href="#">MSZS700528</a>
Plate 28mm dia, transparent, "ZU"	9004840672350		<a href="#">MSZS700628</a>
Plate 28mm dia, transparent, "BETRIEB"	9004840672367		<a href="#">MSZS700728</a>
Plate 28mm dia, transparent, "STÖRUNG"	9004840672374		<a href="#">MSZS700828</a>
Plate 28mm dia, transparent, "START"	9004840672381		<a href="#">MSZS700928</a>
Plate 28mm dia, transparent, "HALT"	9004840672398		<a href="#">MSZS701028</a>
Plate 28mm dia, transparent, "STOP"	9004840672404		<a href="#">MSZS701128</a>
Plate 28mm dia, transparent, "Arrow"	9004840672411		<a href="#">MSZS701528</a>
Plate 28mm dia, transparent, "TEST"	9004840673050		<a href="#">MSZS701828</a>
Plate 28mm dia, transparent, "RESET"	9004840673067		<a href="#">MSZS701928</a>
Plate 28mm dia, transparent, "ON"	9004840673074		<a href="#">MSZS710228</a>
Plate 28mm dia, transparent, "OFF"	9004840673081		<a href="#">MSZS710328</a>
Plate 28mm dia, transparent, "UP"	9004840673098		<a href="#">MSZS710428</a>
Plate 28mm dia, transparent, "DOWN"	9004840673128		<a href="#">MSZS710528</a>
Plate 28mm dia, transparent, "CLOSE"	9004840673135		<a href="#">MSZS710628</a>
Plate 28mm dia, transparent, "RUNNING"	9004840673142		<a href="#">MSZS710728</a>
Plate 28mm dia, transparent, "FAULT"	9004840673104		<a href="#">MSZS710828</a>
Plate 28mm dia, transparent, "OPEN"	9004840673111		<a href="#">MSZS730428</a>

## ■ SERIES MS – COLOURED BUTTONS FOR ILLUMINATED PUSHBUTTONS



MSZX60001

DESCRIPTION	EAN CODE	AVAILABLE	ORDER NO.
Plate for push-button illum., transparent	9004840672596		<a href="#">MSZX7001</a>
Plate for push-button illum., red	9004840672541		<a href="#">MSZX2001</a>
Plate for push-button illum., yellow	9004840672558		<a href="#">MSZX3001</a>
Plate for push-button illum., green	9004840672565		<a href="#">MSZX4001</a>
Plate for push-button illum., blue	9004840672572		<a href="#">MSZX5001</a>
Plate for push-button illum., white	9004840672589		<a href="#">MSZX6001</a>

# MAIN SWITCHES, CONTROL SWITCHES, COMMAND AND SIGNALLING DEVICES

## ■ SERIES MS – KNOBS FOR SELECTOR SWITCHES



MSK010305R

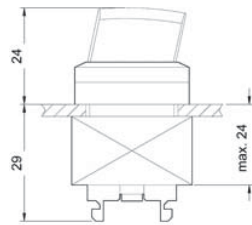

DIMENSIONS

### ■ SCHRACK INFO

- IP 66
- Diameter 28.5 mm
- 2 or 3 positions
- Operating angle: 50°, 2 x 50° or 90°

DESCRIPTION	EAN CODE	AVAILABLE	ORDER NO.
<b>2 POSITIONS SPRING-RETURN</b>			
Knob, 2pos., 50°	9004840670929		<a href="#">MSK010205T</a>
<b>2 POSITIONS LATCHING</b>			
Knob, 2pos., 50°, latching	9004840670912		<a href="#">MSK010205R</a>
Knob, 2pos., 90°, latching	9004840670936		<a href="#">MSK010209R</a>
<b>3 POSITIONS SPRING-RETURN</b>			
Knob, 3pos., 2x50°	9004840670950		<a href="#">MSK010305T</a>
<b>3 POSITIONS LATCHING</b>			
Knob, 3pos., 2x50°, latching	9004840670943		<a href="#">MSK010305R</a>
<b>3 POSITIONS SPRING-RETURN / LATCHING</b>			
Knob 3pos., 2x50°, latching right	9004840672725		<a href="#">MSK010307R</a>
Knob 3pos., 2x50°, latching left	9004840672732		<a href="#">MSK010307T</a>

## ■ SERIES MS – ILLUMINATED KNOBS FOR SELECTOR SWITCHES, 2 POSITIONS



MSKB2030

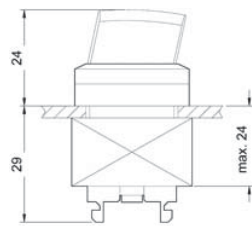

DIMENSIONS

### ■ SCHRACK INFO

- IP 66
- Diameter 28.5 mm
- Operating angle: 50°
- Carrier included (for 2 contact elements + LED)

DESCRIPTION	EAN CODE	AVAILABLE	ORDER NO.
<b>SPRING-RETURN</b>			
Knob illum., red, 2pos., 50°	9004840673159		<a href="#">MSKB2020T</a>
Knob illum., yellow, 2pos., 50°	9004840673166		<a href="#">MSKB3020T</a>
Knob illum., green, 2pos., 50°	9004840673180		<a href="#">MSKB4020T</a>
Knob illum., blue, 2pos., 50°	9004840673197		<a href="#">MSKB5020T</a>
Knob illum., transparent, 2pos., 50°	9004840671148		<a href="#">MSKB7020T</a>
<b>LATCHING</b>			
Knob illum., red, 2pos., 50°, latching	9004840670981		<a href="#">MSKB2020R</a>
Knob illum., yellow, 2pos., 50°, latching	9004840671025		<a href="#">MSKB3020R</a>
Knob illum., green, 2pos., 50°, latching	9004840671056		<a href="#">MSKB4020R</a>
Knob illum., blue, 2pos., 50°, latching	9004840671100		<a href="#">MSKB5020R</a>
Knob illum., transparent, 2pos., 50°, latching	9004840671131		<a href="#">MSKB7020R</a>



Order no. blue: on stock, usually ready for delivery on the day of order!





# MAIN SWITCHES, CONTROL SWITCHES, COMMAND AND SIGNALLING DEVICES

## ■ SERIES MS – ILLUMINATED KNOBS FOR SELECTOR SWITCHES, 3 POSITIONS



MSKB3020

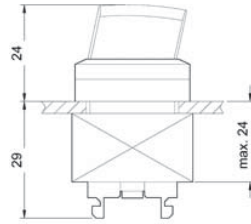

DIMENSIONS

### ■ SCHRACK INFO

- IP 66
- Diameter 28.5 mm
- Operating angle: 2 x 50°
- Carrier included (for 2 contact elements + LED)

DESCRIPTION	EAN CODE	AVAILABLE	ORDER NO.
<b>SPRING-RETURN</b>			
Knob illum., red, 3pos., 2x50°	9004840672749		<b>MSKB2030T</b>
Knob illum., yellow, 3pos., 2x50°	9004840672756		<b>MSKB3030T</b>
Knob illum., green, 3pos., 2x50°	9004840671070		<b>MSKB4030T</b>
Knob illum., blue, 3pos., 2x50°	9004840672763		<b>MSKB5030T</b>
Knob illum., transparent, 3pos., 2x50°	9004840671179		<b>MSKB7030T</b>
<b>LATCHING</b>			
Knob illum., red, 3pos., 2x50°, latching	9004840670998		<b>MSKB2030R</b>
Knob illum., yellow, 3pos., 2x50°, latching	9004840673173		<b>MSKB3030R</b>
Knob illum., green, 3pos., 2x50°, latching	9004840671063		<b>MSKB4030R</b>
Knob illum., blue, 3pos., 2x50°, latching	9004840673203		<b>MSKB5030R</b>
Knob illum., transparent, 3pos., 2x50°, latching	9004840671155		<b>MSKB7030R</b>
<b>SPRING-RETURN / LATCHING</b>			
Knob illum., red, 3pos., 2x50°, latching right	9004840671018		<b>MSKB2030TR</b>
Knob illum., yellow, 3pos., 2x50°, latching right	9004840671049		<b>MSKB3030TR</b>
Knob illum., green, 3pos., 2x50°, latching right	9004840671094		<b>MSKB4030TR</b>
Knob illum., blue, 3pos., 2x50°, latching right	9004840671124		<b>MSKB5030TR</b>
Knob illum., transparent, 3pos., 2x50°, latching right	9004840671186		<b>MSKB7030TR</b>
Knob illum., red, 3pos., 2x50°, latching left	9004840671001		<b>MSKB2030RT</b>
Knob illum., yellow, 3pos., 2x50°, latching left	9004840671032		<b>MSKB3030RT</b>
Knob illum., green, 3pos., 2x50°, latching left	9004840671087		<b>MSKB4030RT</b>
Knob illum., blue, 3pos., 2x50°, latching left	9004840671117		<b>MSKB5030RT</b>
Knob illum., transparent, 3pos., 2x50°, latching left	9004840671162		<b>MSKB7030RT</b>



### I KNOW WHERE TO FIND IT!

WITH THE SCHRACK TECHNIK LIVE-PHONE APP

- Access technical product information at any time and from everywhere
- See availability and price immediately
- Order desired products easily

# MAIN SWITCHES, CONTROL SWITCHES, COMMAND AND SIGNALLING DEVICES

## ■ SERIES MS – HOLDER AND CARRIERS



MSZH0001



MSZX0002



MSZX0003



DIMENSIONS

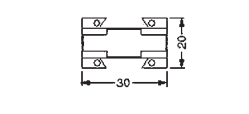

DIMENSIONS

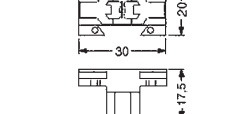

DIMENSIONS

### ■ SCHRACK INFO

- For front mounting of switch and signaling elements
- Up to either 2 contact elements or 1 LED can be mounted on the holder
- Holders are included at all control devices
- Carriers are included at all illuminated control devices
- Up to 3 contact elements or 1 LED + 2 contact elements can be fixed by use of carrier
- Use carrier with pressure plate for actuating the central of 3 contact elements (key switch, twin push button)

DESCRIPTION	EAN CODE	AVAILABLE	ORDER NO.
Holder for devices 22,3mm bore (1-4mm panels)	9004840671667		<a href="#">MSZH0001</a>
Carrier for 2 contact blocks + LED	9004840672473		<a href="#">MSZX0002</a>
Carrier for 3 contact blocks	9004840672480		<a href="#">MSZX0003</a>

## ■ SERIES MS – CONTACT ELEMENTS



MSZK0300C



MSZK0100

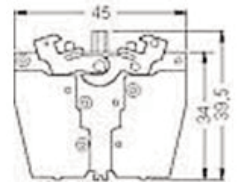

DIMENSIONS

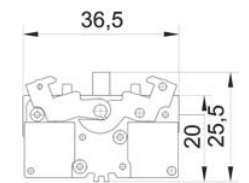

DIMENSIONS

### ■ SCHRACK INFO

- Available with spring-type or with screw terminals
- Breaking capacity:  
AC15, 230V, 6A  
DC13, 24V, 3A

DESCRIPTION	EAN CODE	AVAILABLE	ORDER NO.
<b>WITH SCREW TERMINALS</b>			
Contact block , 1 NO, screw conn.	9004840671674		<a href="#">MSZK0100</a>
Contact block , 1 NC, screw conn.	9004840671698		<a href="#">MSZK0200</a>
<b>WITH SPRING-TYPE TERMINALS</b>			
Contact block , 1 NO, spring-type terminals	9004840671681		<a href="#">MSZK0100C</a>
Contact block , 1 NC, spring-type terminals	9004840671704		<a href="#">MSZK0200C</a>
Contact block , 2 NO, spring-type terminals	9004840671711		<a href="#">MSZK0300C</a>
Contact block , 2 NC, spring-type terminals	9004840671728		<a href="#">MSZK0400C</a>
Contact block , 1 NO + 1 NC, spring-type terminals	9004840671735		<a href="#">MSZK0500C</a>
Contact block , 1 early make NO + 1 delayed NC, spring-type terminals	9004840671742		<a href="#">MSZK0600C</a>

Order no. blue: on stock, usually ready for delivery on the day of order!

# MAIN SWITCHES, CONTROL SWITCHES, COMMAND AND SIGNALLING DEVICES

## ■ SERIES MS – LED, LAMPHOLDER AND LAMPS



MSZL6003



MSZF000



LAMP

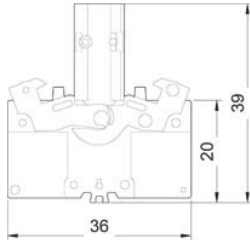

DIMENSIONS

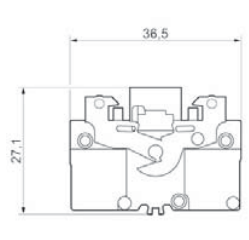

DIMENSIONS

### ■ SCHRACK INFO

- 2 supply voltages: LED's 24V AC/DC and lamps 230V AC
- Spring-type terminals, screw terminals or BA9s socket types
- For lamps, additional holder required

DESCRIPTION	EAN CODE	AVAILABLE	ORDER NO.
<b>LED FOR 24V AC/DC – SCREW TERMINALS</b>			
LED unit, red, 24VAC/DC	9004840671766		<b>MSZL2005</b>
LED unit, green, 24VAC/DC	9004840671803		<b>MSZL4005</b>
LED unit, blue, 24VAC/DC	9004840671834		<b>MSZL5005</b>
LED unit, white, 24VAC/DC	9004840671872		<b>MSZL6005</b>
<b>LED FOR 230V AC – SCREW TERMINALS</b>			
LED unit, red, 230VAC	9004840671759		<b>MSZL2003</b>
LED unit, green, 230VAC	9004840671780		<b>MSZL4003</b>
LED unit, blue, 230VAC	9004840671827		<b>MSZL5003</b>
LED unit, white, 230VAC	9004840671858		<b>MSZL6003</b>
<b>LED FOR 24V AC/DC – SPRING-TYPE TERMINALS</b>			
LED unit, red, 24VAC/DC, spring-type terminals	9004840671773		<b>MSZL2005C</b>
LED unit, green, 24VAC/DC, spring-type terminals	9004840671810		<b>MSZL4005C</b>
LED unit, blue, 24VAC/DC, spring-type terminals	9004840671841		<b>MSZL5005C</b>
LED unit, white, 24VAC/DC, spring-type terminals	9004840671889		<b>MSZL6005C</b>
<b>LED FOR 230V AC – SPRING-TYPE TERMINALS</b>			
LED unit, red, 230VAC, spring-type terminals	9004840672794		<b>MSZL2003C</b>
LED unit, green, 230VAC, spring-type terminals	9004840671797		<b>MSZL4003C</b>
LED unit, blue, 230VAC, spring-type terminals	9004840672770		<b>MSZL5003C</b>
LED unit, white, 230VAC, spring-type terminals	9004840671865		<b>MSZL6003C</b>
<b>HOLDER FOR LAMPS BA9s</b>			
Holder for Lamps BA9s	9004840671650		<b>MSZF000</b>

# MAIN SWITCHES, CONTROL SWITCHES, COMMAND AND SIGNALLING DEVICES

## ■ SERIES MS – KNOB FOR POTENTIOMETERS



MSZX1011

### ■ SCHRACK INFO

- Scale from 1. – 10
- Potentiometers to be ordered separately

DESCRIPTION	EAN CODE	AVAILABLE	ORDER NO.
Rotary knob for potentiometer, scale 0...10, axle 6mm dia	9004840672534		<b>MSZX1011</b>

## ■ SERIES MS – SURFACE ENCLOSURES



MSG



MSG31000

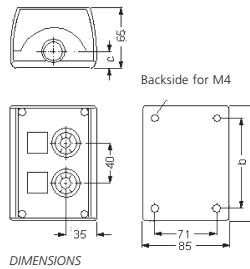

DESCRIPTION	EAN CODE	AVAILABLE	ORDER NO.
Box, surf. mounted, 1-hole, black/gray	9004840670769		<b>MSG11000</b>
Box, surf. mounted, 1-hole, black/yellow	9004840670721		<b>MSG13000</b>
Box, surf. mounted, 2-holes, black/gray	9004840670783		<b>MSG21000</b>
Box, surf. mounted, 3-holes, black/gray	9004840670790		<b>MSG31000</b>
Box, surf. mounted, 4-holes, black/gray	9004840670806		<b>MSG41000</b>
Box, surf. mounted, 6-holes, black/gray	9004840670813		<b>MSG61000</b>



### I KNOW WHERE TO FIND IT!

THE SCHRACK TECHNIK WEB SHOP WITH NAVIGATOR  
[WWW.SCHRACK.COM](http://WWW.SCHRACK.COM)

- Finding product information made easy
- Buying products around the clock
- Quick access customer service



Order no. blue: on stock, usually ready for delivery on the day of order!



# MAIN SWITCHES, CONTROL SWITCHES, COMMAND AND SIGNALLING DEVICES

## SERIES MS – TAG HOLDERS AND PLATES



MSZT1210



MSZT1710



MSZT2710



MSZT122070

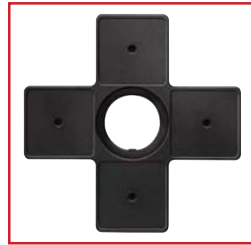

MSJT2740



MSJT2720

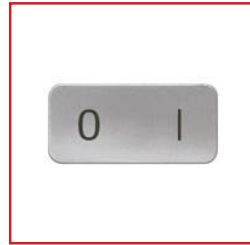

MSZS001417



MSZS308080

DESCRIPTION	EAN CODE	AVAILABLE	ORDER NO.
<b>TAG HOLDERS FOR ADHESIVE PLATE 12,5x27mm</b>			
Tag holder for adhesive plate 12,5x27mm	9004840672428		<b>MSZT1210</b>
Tag holder f. twin PB (for adhesive plate 12,5x27mm)	9004840672435		<b>MSZT122070</b>
<b>TAG HOLDER FOR SNAP-IN PLATE 17,5x28mm</b>			
Tag holder for snap-in plate 17,5x28mm	9004840672442		<b>MSZT1710</b>
<b>TAG HOLDERS FOR ADHESIVE PLATE 27x27mm</b>			
Tag holder for adhesive plate 27x27mm	9004840672459		<b>MSZT2710</b>
Tag holder for joystick 2pos., horizontal (f. 2 plates 27x27)	9004840670882		<b>MSJT2720H</b>
Tag holder for joystick 2pos., vertical (f. 2 plates 27x27)	9004840670899		<b>MSJT2720V</b>
Tag holder for joystick 4pos., (f. 4 plates 27x27)	9004840670905		<b>MSJT2740</b>
<b>PLATES ADHESIVE 12,5x27mm</b>			
Plate 12,5x27mm, Alu, adhesive, w/o text	9004840672787		<b>MSZS000012</b>
Plate 12,5x27mm, Alu, adhesive, Arrow vertikal	9004840672886		<b>MSZS001512</b>
Plate 12,5x27mm, Alu, adhesive, Arrow horizontal	9004840672893		<b>MSZS001612</b>
<b>PLATES SNAP-IN 17,5x28mm</b>			
Plate 17,5x28mm, Alu, snap-in, "EIN"	9004840671902		<b>MSZS000217</b>
Plate 17,5x28mm, Alu, snap-in, "AUS"	9004840671919		<b>MSZS000317</b>
Plate 17,5x28mm, Alu, snap-in, "AUF"	9004840671926		<b>MSZS000417</b>
Plate 17,5x28mm, Alu, snap-in, "AB"	9004840671933		<b>MSZS000517</b>
Plate 17,5x28mm, Alu, snap-in, "ZU"	9004840671940		<b>MSZS000617</b>
Plate 17,5x28mm, Alu, snap-in, "BETRIEB"	9004840671957		<b>MSZS000717</b>
Plate 17,5x28mm, Alu, snap-in, "STÖRUNG"	9004840671964		<b>MSZS000817</b>
Plate 17,5x28mm, Alu, snap-in, "START"	9004840671971		<b>MSZS000917</b>
Plate 17,5x28mm, Alu, snap-in, "HALT"	9004840671988		<b>MSZS001017</b>
Plate 17,5x28mm, Alu, snap-in, "STOP"	9004840671995		<b>MSZS001117</b>
Plate 17,5x28mm, Alu, snap-in, "STOP START"	9004840672008		<b>MSZS001217</b>
Plate 17,5x28mm, Alu, snap-in, "HAND AUTO"	9004840672015		<b>MSZS001317</b>
Plate 17,5x28mm, Alu, snap-in, "0 I"	9004840672022		<b>MSZS001417</b>
Plate 17,5x28mm, Alu, snap-in, symbol "Arrow vertikal"	9004840672039		<b>MSZS001517</b>
Plate 17,5x28mm, Alu, snap-in, symbol "Arrow horizont."	9004840672046		<b>MSZS001617</b>
Plate 17,5x28mm, Alu, snap-in, w/o text	9004840672053		<b>MSZS001717</b>
Plate 17,5x28mm, Alu, snap-in, "ON"	9004840672909		<b>MSZS010217</b>
Plate 17,5x28mm, Alu, snap-in, "OFF"	9004840672916		<b>MSZS010317</b>
Plate 17,5x28mm, Alu, snap-in, "UP"	9004840672947		<b>MSZS010417</b>
Plate 17,5x28mm, Alu, snap-in, "DOWN"	9004840672948		<b>MSZS010517</b>

# MAIN SWITCHES, CONTROL SWITCHES, COMMAND AND SIGNALLING DEVICES

## ■ SERIES MS – TAG HOLDERS AND PLATES – continued

DESCRIPTION	EAN CODE	AVAILABLE	ORDER NO.
<b>PLATES SNAP-IN 17,5x28mm</b>			
Plate 17,5x28mm, Alu, snap-in, "CLOSE"	9004840672985		<a href="#">MSZS010617</a>
Plate 17,5x28mm, Alu, snap-in, "RUNNING"	9004840672992		<a href="#">MSZS010717</a>
Plate 17,5x28mm, Alu, snap-in, "FAULT"	9004840673005		<a href="#">MSZS010817</a>
Plate 17,5x28mm, Alu, snap-in, "MAN AUTO"	9004840673012		<a href="#">MSZS011317</a>
Plate 17,5x28mm, Alu, snap-in, "AUS EIN"	9004840672923		<a href="#">MSZS020317</a>
Plate 17,5x28mm, Alu, snap-in, "OFFEN"	9004840672954		<a href="#">MSZS020417</a>
Plate 17,5x28mm, Alu, snap-in, "HAND 0 AUTO"	9004840673029		<a href="#">MSZS021317</a>
Plate 17,5x28mm, Alu, snap-in, "I 0 II "	9004840673043		<a href="#">MSZS021417</a>
Plate 17,5x28mm, Alu, snap-in, "OFF ON"	9004840672930		<a href="#">MSZS030317</a>
Plate 17,5x28mm, Alu, snap-in, "OPEN"	9004840672961		<a href="#">MSZS030417</a>
Plate 17,5x28mm, Alu, snap-in, "MAN 0 AUTO"	9004840673036		<a href="#">MSZS031317</a>
<b>PLATES ADHESIVE 27x27mm</b>			
Plate 27x27mm, Alu, adhesive, w/o text	9004840671896		<a href="#">MSZS000027</a>
<b>PLATES FOR EMERGENCY STOP PUSH-BUTTONS</b>			
Plate 60mm dia, yellow, "NOT-HALT" G, E, Ital, Spain	9004840672251		<a href="#">MSZS306060</a>
Plate 80mm dia, yellow, w/o text	9004840672268		<a href="#">MSZS300080</a>
Plate 80mm dia, yellow, "NOT-HALT" G, E, Ital, Spain	9004840672275		<a href="#">MSZS306080</a>
Plate 80mm dia, yellow, "NOT-AUS"	9004840672282		<a href="#">MSZS308080</a>

## ■ SERIES MS – ACCESSORIES



MSZX0006



MSZX1001



MSZX0001



MSZX1002

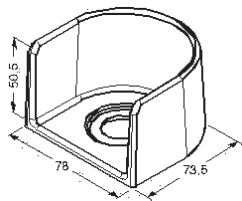

DIMENSIONS

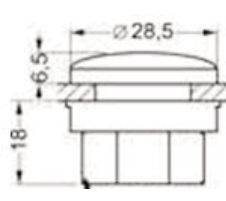

DIMENSIONS

DESCRIPTION	EAN CODE	AVAILABLE	ORDER NO.
<b>PROTECTIVE COVER</b>			
Protection cover, transparent, for push-buttons (IP67)	9004840672466		<a href="#">MSZX0001</a>
<b>PROTECTIVE COLLAR</b>			
Protective collar for Emergency-stop switches, yellow	9004840672510		<a href="#">MSZX0006</a>
<b>BLIND COVER</b>			
Blind-cover black, 22,3mm bore	9004840672527		<a href="#">MSZX1001</a>
<b>DISMANTLING TOOLS</b>			
Dismantling tool for devices with cage clamp	9004840684032		<a href="#">MSZX1002</a>
Dismantling tool for devices with screw connection	9004840684049		<a href="#">MSZX1003</a>



Order no. blue: on stock, usually ready for delivery on the day of order!